

Horizontal Clamps



PAVLÍNEK
VÁZACÍ PROSTŘEDKY

EMAIL: OBCHOD@PAVLÍNEK.CZ
TEL: +420 595 693 911
SALOUNOVA 746/31, OSTRAVA VÍTKOVICE
IČ: 25358511 DIČ: CZ25358511



IPBC

The IPBC horizontal lifting clamps have a pretension feature that allows the user to attach the clamps to the material for horizontal lifting and transfer of sagging and non-sagging material. These clamps may also be used to handle material that will be used in shears, bending and rolling machines or other fabrication equipment. May also be used for turning beams from the "H" into the "I" position.

For horizontal transfer - with pretension system

- Available in capacities of 1 thru 4.5 metric tons.
- Jaw openings available: 0 to 40mm.
- Welded alloy steel body for strength and smaller size. Forged alloy components, where required.
- Individually Proof Tested to 2 times the Working Load Limit with certpermanently stamped on body.
- Each product is individually serialized, with the serial number and Proof Load test date stamped on body. User manual with test certificate is included with each clamp.
- Maintenance and repair kits are available.
- Manufactured by an ISO 9001 facility.
- All sizes are **RFID EQUIPPED**.



IPHGZ

The IPHGZ, IPHGZ horizontal lifting clamps have a pretension locking feature that allows the user to attach the clamps to the material for horizontal lifting and transfer of sagging and non-sagging material. These clamps may also be used to handle material that will be used in shears, bending and rolling machines or other fabrication equipment. May also be used to move and lift structural shapes such as I-Beams, H-beams etc.



Load Rated

Model IPBC

Model	Working Load Limit (t)*	IPBC Stock No.	Weight Each (kg)	Dimensions (mm)									
				Jaw A	B	C	E	F	G	H	J	K	L
IPBC	1	2700410	3.5	0 - 20	132	52	26	75	185	36	16	182	12
IPBC	2	2700411	6.5	0 - 25	152	62	30	82	210	49	20	218	15
IPBC	3	2700412	8.5	0 - 25	157	66	30	82	210	57	20	225	15

* Design Factor based on EN 13155 and ASME B30.20.

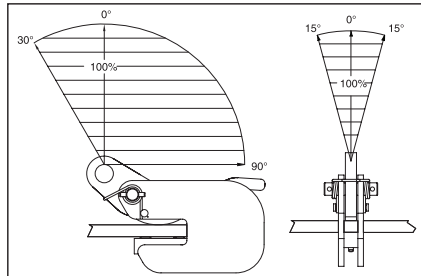
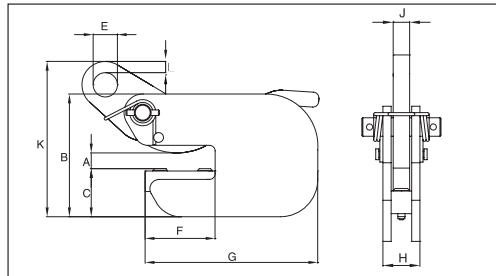

Model IPHGZ: Universal Lifting Eye / Model IPHGZ: Fixed Hoisting Eye

Model	Working Load Limit (t)*	IPHGZ Stock No.	Weight Each (kg)	Dimensions (mm)									
				Jaw A	B	C	D	E	F	G	J	K	
IPHGZ	1.5	2705455	9.0	0 - 25	110	232	287	70	139	90	20	16	
IPHGZ	3.0	2705456	19.9	0 - 40	119	253	348	75	175	120	25	20	
IPHGZ	4.5	2705457	30.0	0 - 40	119	301	370	80	175	155	30	44	
Fixed Hoisting Eye													
IPHGZ	.75	2705451	4.0	0 - 25	82	148	206	50	99	98	12	22	
IPHGZ	1.5	2705452	7.3	0 - 25	110	200	250	50	118	90	20	28	
IPHGZ	3.0	2705453	12.3	0 - 40	120	227	305	70	148	120	25	32	
IPHGZ	4.5	2705454	25.0	0 - 40	120	284	381	70	181	155	30	40	

* Design Factor based on EN 13155 and ASME B30.20.

