

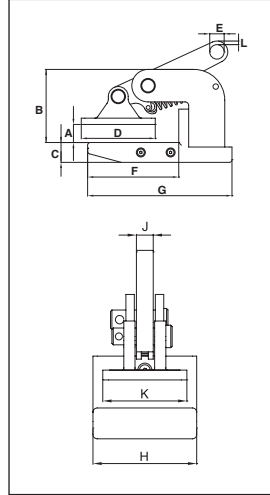

**IPHNM10**

The IPHNM10 horizontal lifting clamps have a pretension feature that allows the user to attach the clamps to the material for horizontal lifting and transfer of non-sagging material. To be used where material surface must not be damaged. These clamps must be used in pairs or more.



**IPH10**

The IPH10 horizontal lifting clamps with spring loaded tension have a pretension feature that allows the user to attach the clamps to the material for horizontal lifting and transfer of non-sagging material. These clamps must be used in pairs or more.

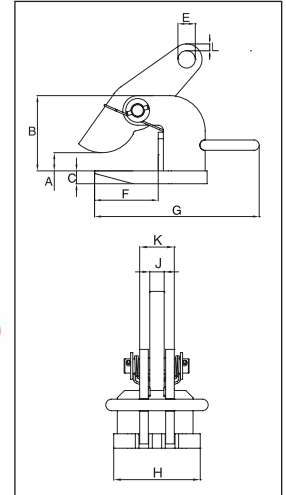

**For horizontal lift and transfer with pretension system**

- Available in capacities of .5 thru 12 metric tons.
- Jaw openings available: 0 to 120mm.
- Welded alloy steel body for strength and smaller size. Forged alloy components, where required.
- Individually Proof Tested to 2 times the Working Load Limit with certification.
- Company name (CrosbyIP), logo, Working Load Limit and jaw opening permanently stamped on body.
- Each product is individually serialized, with the serial number and Proof Load test date stamped on body. User manual with test certificate is included with each clamp.
- Maintenance and repair kits are available.
- Manufactured by an ISO 9001 facility.
- All sizes are **RFID EQUIPPED**.



**Load Rated**

**Model IPHNM10**

Model	Working Load Limit (Per Pair) (t)*	IPHNM10 Stock No.	Weight Each (kg)	Dimensions (mm)										
				Jaw A	B	C	D	E	F	G	H	J	K	L
IPHNM10	.5	2703287	4.0	0 - 20	81	22	82	16	101	160	74	12	60	4
IPHNM10	1	2703288	7.0	0 - 35	93	30	92	16	103	164	74	12	60	7
IPHNM10	2	2703290	15.0	0 - 30	139	30	131	22	166	245	100	20	74	9
IPHNM10J	2	2703291	16.0	30 - 60	169	30	131	22	166	245	100	20	74	9

\* Design Factor based on EN 13155 and ASME B30.20.

**Model IPH10 and IPH10J: With Spring Loaded Tension, Magnets and Handle**

Model	Working Load Limit (Per Pair) (t)*	IPH10 Stock No.	Weight Each (kg)	Dimensions (mm)										
				Jaw A	B	C	E	F	G	H	J	K	L	
IPH10	.5+	2703297	1.8	0 - 20	86	12	16	103	150	60	12	27	4	
IPH10	1+	2703298	2.5	0 - 35	100	16	16	103	150	60	12	31	7	
IPH10	2	2703522	5.5	0 - 60	117	16	22	109	256	110	20	40	9	
IPH10	3	2703523	7.5	0 - 60	117	20	26	109	266	120	20	48	11	
IPH10	4.5	2703524	10.5	0 - 60	132	25	30	104	280	130	20	48	12	
IPH10	6	2703525	13.0	0 - 60	143	25	36	123	320	130	20	48	14	
IPH10	9	2703526	18.5	0 - 60	157	30	43	133	330	140	25	62	16	
IPH10	12	2703527	21.5	0 - 60	172	30	47	141	353	150	25	62	17	
<b>With larger jaw opening #</b>														
IPH10J	3	2703533	18.0	60 - 120	177	20	26	109	266	120	20	48	9	
IPH10J	4.5	2703534	24.0	60 - 120	192	25	30	104	280	130	20	48	11	
IPH10J	6	2703535	30.0	60 - 120	203	25	36	123	320	130	20	48	12	
IPH10J	9	2703536	41.0	60 - 120	217	30	43	133	330	140	25	62	14	
IPH10J	12	2703537	41.0	60 - 120	232	30	47	141	353	150	25	62	16	

\* Design Factor based on EN 13155 and ASME B30.20. + No handle or magnets. # Larger Working Load Limits available.

